



MCE-2 Series 3ns Solid-state Lasers

Applications

- Seed laser
- Micromachining
- Biomedicine
- Laser-induced breakdown spectroscopy (LIBS)
- Laser-induced plasma spectroscopy (LIPS)
- LIDAR

Key Features

- ◆ High average power and small size
- ◆ Spatial mode TEM₀₀
- ◆ Sealed package, high reliability
- ◆ Polarization-stable

Technical Specifications

Optical Parameters	
Wavelength (nm)	1064
Repetition rate (kHz)	2.5 10
Average power (mW)	500 800
Pulse energy (μJ)	200 80
Pulse width (ns)	3 2.5
Power stability (8h)	±3%
Beam profile	TEM ₀₀
Collimated beam diameter (mm)	≈5
Beam divergence, full angle (typ., @1/e ² , mrad)	≤1
Polarization ratio	>100:1
System Parameters	
Supply power voltage	18V, >72W
External trigger	Gated, 5V TTL, drive high to enable laser
Laser head dimensions (W×H×L, mm)	32×21×110
Operation temperature (°C, require air cooling)	15~35
Storage temperature (°C)	-20~60

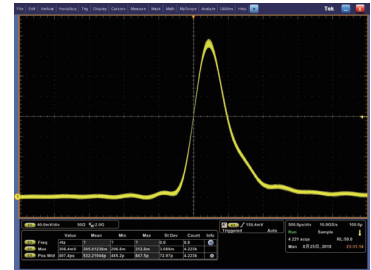

Typical Pulse

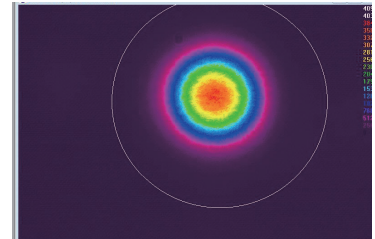

Beam Profile

Mechanical Drawings (in mm)

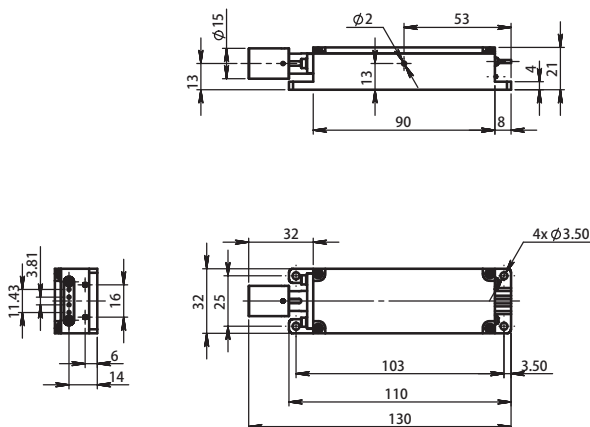

Drawings

