

R3 Diode Laser Components

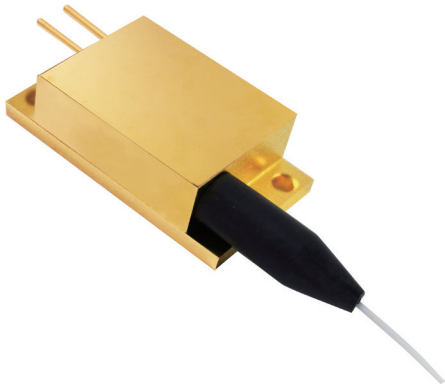

Applications

- Pumping source
- Laser machining
- Scientific research

Technical Specifications (25°C)

Package Type		R3	
Center Wavelength (nm)		808	976
Optical	CW Output Power / Pop (W)	20	25
	Wavelength Tolerance (nm)	±0.5	
	Spectral Width / $\Delta\lambda$ (nm)	< 0.5	
	Temperature Drift of Wavelength / $\Delta\lambda/\Delta T$ (nm/°C)	0.03	
Electrical	Threshold Current / Ith (A)	1.4	0.6
	Operating Current / Iop (A)	9	12
	Operating Voltage / Vop (V)	5.5	6
	Slope Efficiency / η_{sp} (W/A)	2.6	2.2
Fiber	Fiber Core Diameter / dcore (μm)	200	105
	Fiber Cladding Diameter / Dclad (μm)	220	125
	Fiber Coating Diameter / Dbuffer (μm)	400	250
	Fiber Length / L (cm)	100±10 (Customizable)	
	Numerical Aperture	0.22	
	Connector	SMA905	

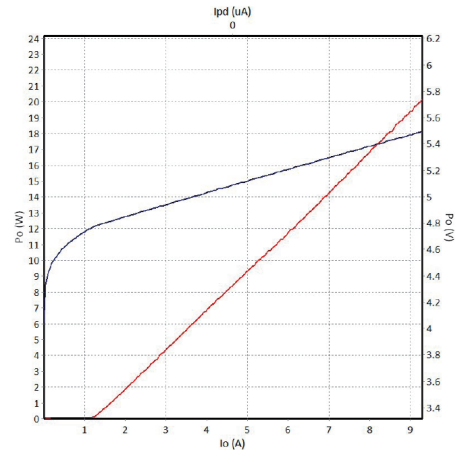

808nm P-I-V Graph

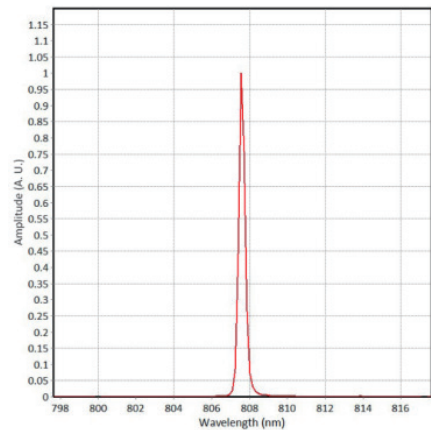

808nm Spectrum

Other Parameters

Parameter	Operating Temperature /°C	Operating Relative Humidity /%	Storage Temperature /°C	Storage Relative Humidity /%	Lead Soldering Temperature (max/°C)
Min	10	-	-20	-	-
Max	30	75	70	90	250(10Sec.)

Order Information

Package	Wavelength (nm)	Output Power (W)	Part Number
R3	808	20	R808±0.5-20WF-R3-G
	976	25	R976±0.5-25WF-R3-G

Part Numbering Schema

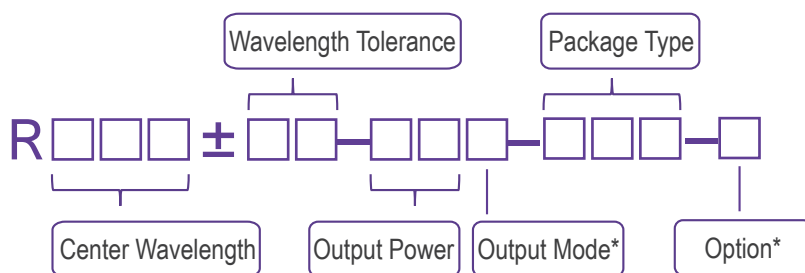

*Output Mode: F - Fiber Pigtailed

*Option: G - Narrow Linewidth

Mechanical Drawings (in mm)

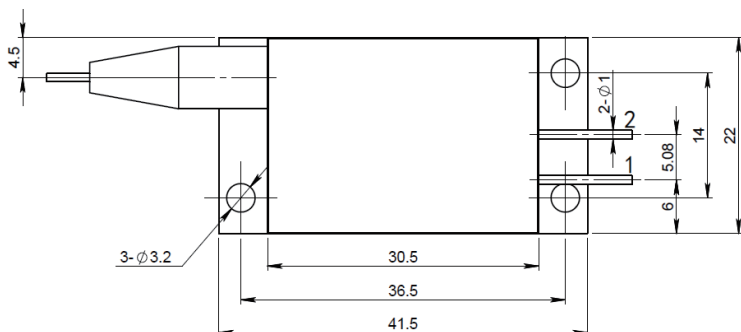
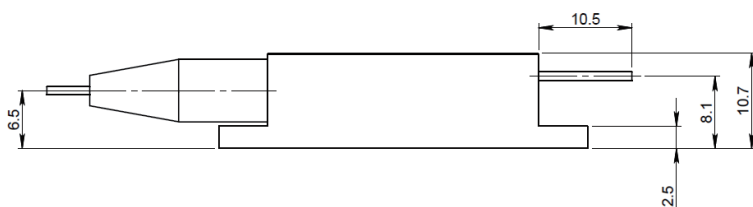

Pin	Function
1	Laser (+)
2	Laser (-)

